



SWASTHI
HOMES

SWASTHI
Paradise

Elegant Living, Serene Homes.



SWASTHI

Paradise



K-RERA/PRJ/ERN/162/2024

rera.kerala.gov.in



SWASTHI Paradise



UNIT D - 3 BHK

UNIT E - 3 BHK

UNIT C - 2 BHK

UNIT A - 3 BHK

LOBBY

UNIT B - 3 BHK

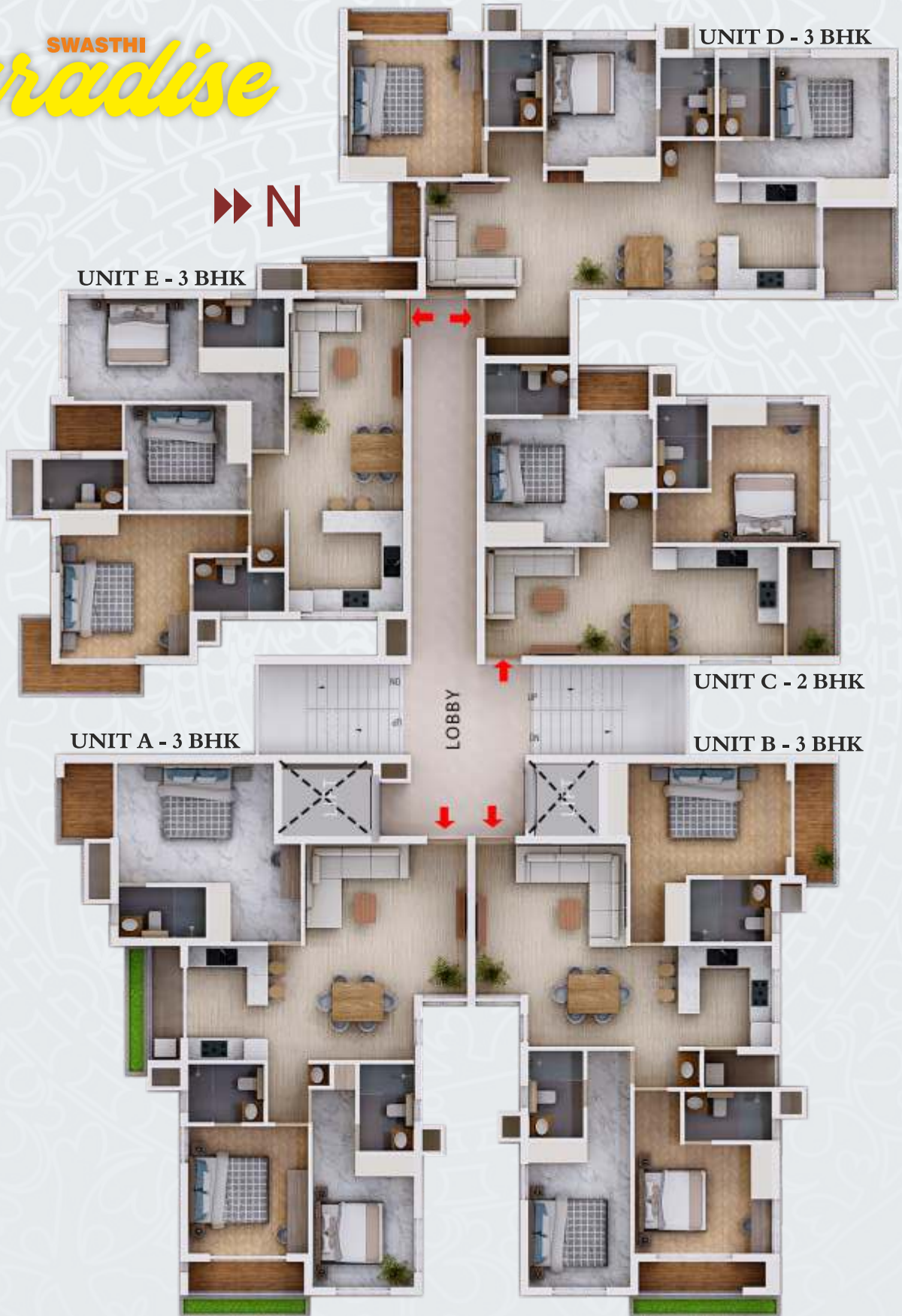

SWASTHI Paradise

» Dimensions may vary slightly during construction » Furniture and fixtures are indicative only » All dimensions are in cm. » Structural members may slightly vary after final design » Carpet area as per Kerala RERA is the area excluding external walls and balcony / verandah » Carpet area is calculated as per structural measurement and may vary slightly with respect to plastering and tiling thickness



GROUND FLOOR



TERRACE



SWASTHI
HOMES



SWASTHI
Paradise

Elegant Living, Serene Homes.



Welcome to Swasthi Paradise

Nestled in the heart of Tripunithura, Swasthi Paradise is where elegance meets comfort. This premium apartment project by Swasthi Homes offers you the luxury of modern living in a location steeped in cultural heritage. Imagine waking up to breathtaking views, surrounded by lush greenery and serene landscapes, all while being just a stone's throw away from the vibrant city life. Swasthi Paradise is designed to cater to your every need, offering spacious layouts, top-of-the-line amenities, and a community that feels like family.

Every detail at Swasthi Paradise is meticulously crafted to ensure a life of peace, comfort, and happiness. From state-of-the-art security systems to recreational facilities, we've thought of everything to make your life here as convenient and enjoyable as possible.

Join the many who have found their happy home at Swasthi Paradise. Embrace a lifestyle of luxury, convenience, and serenity. Discover the true meaning of premium living with Swasthi Homes.

Features & Amenities:

- Prime location in Tripunithura.
- Spacious and elegant apartments.
- Modern amenities including a gym and clubhouse.
- 24/7 security and surveillance.
- Landscaped gardens and children's play area.
- Proximity to schools, hospitals, and shopping center.

SWASTHI
Paradise

Come home to Swasthi Paradise
Where everyday feels like a vacation

SWASTHI Paradise



KEY PLAN



PLAN A: 3BHK

BUILT-UP AREA: 1235 SQ. FT.

SUPER BUILT-UP AREA: 1460 SQ. FT.



▶ Dimensions may vary slightly during construction ▶ Furniture and fixtures are indicative only. ▶ All dimensions are in cm. ▶ Structural members may slightly vary after final design ▶ Carpet area as per Kerala RERA is the area excluding external walls and balcony / verandah ▶ Carpet area is calculated as per structural measurement and may vary slightly with respect to plastering and tiling thickness

SWASTHI Paradise



KEY PLAN

PLAN B: 3BHK

BUILT-UP AREA: 1234 SQ. FT.

SUPER BUILT-UP AREA: 1460 SQ. FT.



▶ Dimensions may vary slightly during construction ▶ Furniture and fixtures are indicative only. ▶ All dimensions are in cm. ▶ Structural members may slightly vary after final design ▶ Carpet area as per Kerala RERA is the area excluding external walls and balcony / verandah ▶ Carpet area is calculated as per structural measurement and may vary slightly with respect to plastering and tiling thickness

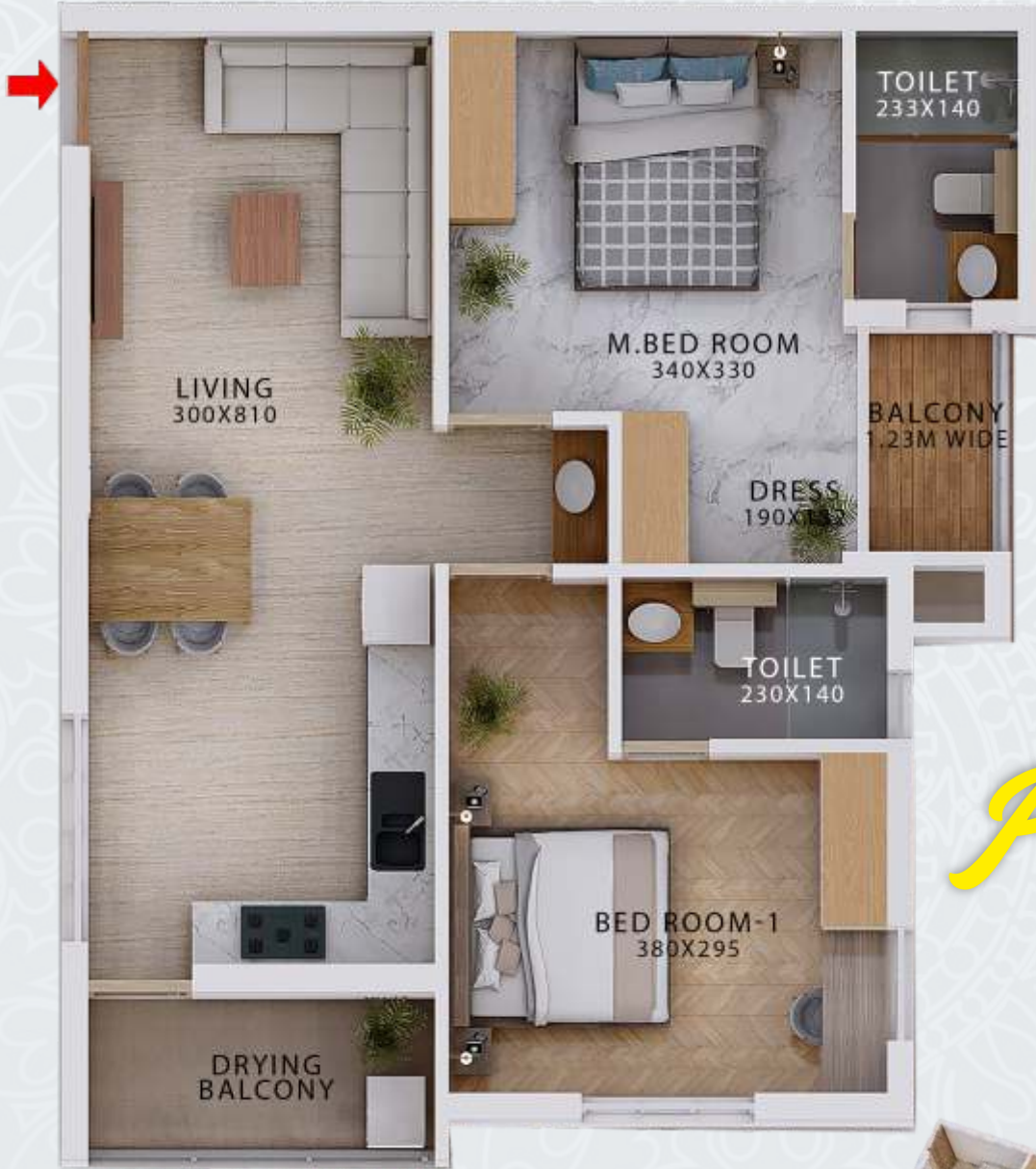

KEY PLAN

SWASTHI
Paradise



PLAN C: 2BHK

BUILT-UP AREA: 835 SQ. FT.

SUPER BUILT-UP AREA: 985 SQ. FT.



▶▶ Dimensions may vary slightly during construction ▶▶ Furniture and fixtures are indicative only. ▶▶ All dimensions are in cm. ▶▶ Structural members may slightly vary after final design ▶▶ Carpet area as per Kerala RERA is the area excluding external walls and balcony / verandah ▶▶ Carpet area is calculated as per structural measurement and may vary slightly with respect to plastering and tiling thickness

SWASTHI Paradise



KEY PLAN



PLAN D: 3BHK

BUILT-UP AREA: 1200 SQ. FT.

SUPER BUILT-UP AREA: 1415 SQ. FT.



▶ Dimensions may vary slightly during construction ▶ Furniture and fixtures are indicative only. ▶ All dimensions are in cm. ▶ Structural members may slightly vary after final design ▶ Carpet area as per Kerala RERA is the area excluding external walls and balcony / verandah ▶ Carpet area is calculated as per structural measurement and may vary slightly with respect to plastering and tiling thickness

SWASTHI
Paradise



PLAN E: 3BHK

BUILT-UP AREA: 1115 SQ. FT.

SUPER BUILT-UP AREA: 1315 SQ. FT.



▶▶ Dimensions may vary slightly during construction ▶▶ Furniture and fixtures are indicative only. ▶▶ All dimensions are in cm. ▶▶ Structural members may slightly vary after final design ▶▶ Carpet area as per Kerala RERA is the area excluding external walls and balcony / verandah ▶▶ Carpet area is calculated as per structural measurement and may vary slightly with respect to plastering and tiling thickness



Facilities:

- Childrens Play Area
- Visitors Car Park
- Recreation Room
- Electric Vehicle Charging Point
- Health Club & Roof Garden
- Generator Back-up
- CCTV, 24 Hours Security
- Solar Power for Common Lighting
- Waste Management System
- Sewage Treatment Plant

Proximity:

- Vadekkekotta Metro Station 500 mtr
- Vadekkekotta Church 400 mtr
- Sree Poornathrayeesa Temple 700 mtr
- Devi Hospital 400 mtr
- VKM Hospital 700 mtr
- NSS School and College 250 mtr
- Chinmaya School 2.0 km
- Choice School 2.5 km
- Vyttila 4.0 km
- Info Park 9.0 km

SWASTHI
Paradise

SPECIFICATIONS

FOUNDATION

- Necessary RCC Foundations on required strata.

STRUCTURE

- Reinforced cement concrete frame with solid cement blocks in fill walls.
- Earth quake resistance as per IS Standards.

FLOORING

- High quality vitrified / rectified tiles with vitrified / rectified tile skirting for living, dining & bathrooms.
- Antiskid / matt tiles - ceramic / vitrified / rectified tiles for kitchen, balcony & toilets. Entrance lobby, staircase & common areas will be of granite / vitrified / rectified tiles flooring.

WALL CLADDING

- Ceramic / vitrified wall tile cladding in bathrooms upto false ceiling height.

KITCHEN

- Granite / full body vitrified slab kitchen counter, single bowl stainless steel sink with drain board.
- Provision for exhaust fan.

TOILET FITTING

- White sanitary ware including European water closet and wash basin.
- Good quality chromium plated taps, mixer, shower and towel rods.

HARDWARE

- Best quality hardware.

DOORS

- Decorative panelled main entrance door in engineered wood.
- Factory made moulded / flush doors for bedrooms and toilets

WINDOWS

- Fully glazed powder coated aluminium / UPVC windows with MS grills

PAINTING

- Putty finished emulsion paint for internal walls and enamel paint for window grills, external walls will be emulsion painted.

WATER SUPPLY

- Provision for KWA water supply at one point in kitchen, subject to rules and regulations of KWA.
- Ground water supply from bore well / ground well.

ELECTRICITY SUPPLY

- Concealed copper wiring.
- Adequate light points, fan points, 6 amps and 16 amps points, etc. with independent meters for each apartment.
- Modular type switches
- Generator back-up upto 1200 Watts per apartment.

PLUMBING

- 3 pipe system for domestic, drinking and flushing water distribution.

WASH ROOMS / POWDER ROOMS

- EWC: Kohler/Roca/Vitra/Queo/Toto or equivalent.
- Wash basin: Kohler/Roca/Vitra/Queo/Toto or equivalent.
- Concealed flush tank: Geberit / Grohe / Viega / Vitra, Queo or equivalent.
- Wall plate: Geberit / Grohe / Viega / Vitra / Queo or equivalent.
- Divertor: Grohe/Kohler/Vitra / Jaguar or equivalent.
- Angle Valve 1/2": Grohe/Jaguar/Vitra/Kohler or equivalent.
- Health Faucet (Abs): Grohe / Jaguar / Vitra / Kohler or equivalent.
- Bottle trap: Jaguar / Essco or equivalent.

FLOORING

- Bedroom floor: RAK / Kajaria / Somany / Simpolo / AGL / Cera / Sunhearrt or equivalent vitrified / rectified tiles.
- Living & dining floor: RAK / Kajaria / Somany / AGL / Simpolo/Cera/Sunhearrt or equivalent vitrified tiles.
- Balcony & sit out: Kajaria / Somany / Simpolo / AGL / Cera / Sunhearrt or equivalent.
- Kitchen floor: Kajaria / Somany / Simpolo / AGL / Cera / Sunhearrt or equivalent.
- Toilet floor: RAK / Kajaria / Somany / Simpolo / AGL / Cera / Sunhearrt or equivalent.
- Toilet wall: RAK / Kajaria / Somany / Simpolo / AGL / Cera / Sunhearrt or equivalent.

DOORS/WINDOWS

- Main door: Engineered wood frame with architrave and designer engineered wood shutter - Ferro / Kassa / Jacson / Jacwud / Kalpataru or equivalent.
- Inside door & toilet door: Kelachandra / Jacson / Kassa / Ferro / Jacwud / Kalpataru or equivalent.
- Windows: Fully glazed aluminium / UPVC windows with high quality MS grills.
- Main door lock: Yale / Dorset / Godrej or equivalent.
- Magnetic catcher: Yale / Magnum / Dorset / Godrej or equivalent.
- Door eye: Yale/Magnum/Dorset/Godrej or equivalent.

- Safety guard: Yale/Magnum/Dorset/Godrej or equivalent.
- Internal doorlock: Yale/Dorset/Godrej or equivalent
- Toilet door baby latch: Yale / Dorset / Godrej or equivalent.
- Hinges: Yale / Magnum / AKS / Godrej or equivalent.
- Tower bolt: Me Gold / Magnum / Madhuram or equivalent.
- Toilet turn latch: EBCO or equivalent.

KITCHEN

- Kitchen sink: Franke / Nirali or equivalent.
- Sink cock: Grohe/Jaguar/Vitra /Kohler or equivalent.
- Cockroach trap: Chilly or equivalent.
- Waste coupling: Chilly or equivalent.

PAINT

- Internal putty: Asian / Berger / Nerolac / BirlaWhite / JK or equivalent.
- Emulsion: Asian / Berger / Jotun / Nerolac / JSW / Indigo or equivalent.
- Exterior emulsion: Asian / Berger / Jotun / JSW / Indigo or equivalent.
- Enamel: Asian / Berger / Nerolac or equivalent.

ELECTRICAL

- Distribution board: Schneider / Legrand / ABB / Havells / Hager / Siemens / L&T or equivalent.
- MCB: Schneider / Legrand / ABB / Havells / Hager / Siemens / L&T or equivalent.
- Switches: Schneider / Legrand / L&T / Honeywell or equivalent.
- Genset: Kirlosker / Cummins or equivalent.
- Transformer: Unipower/Intrans/Resitec or equivalent
- Cables: Finolex / Polycab / Havells / RRRKabel / Gloster / Unistar or equivalent.
- Wires: Finolex / Polycab / V-Guard / RR Kabel or equivalent.

CEMENT & STEEL

- ISI branded.

LIFT

- Fujitek / Kone / Infra / Toshiba / Otis / Thyssenkrupp or equivalent



COMPLETED PROJECTS



Swasthi Prakasha Mandiram



Swasthi Butterfly



SWASTHI HOMES

2nd Floor, RK's Sunrise,
Puzhayoram Road, Near Aquaria Hotel,
Vadakkekotta Tripunithura- 682 301, Ernakulam

Call: 93881 08510, 73065 22107

ONGOING PROJECT



Swasthi Devi Padam
Key Handing Over on
September 2024

UPCOMING PROJECTS

- ✓ Layam Road, Tripunithura.
- ✓ Hill Palace Road, Karingachira, Tripunithura.